

800E ELECTRONIC BALLAST SERIES

A new sleek opal acrylic shallow profile square with soft curvatures evenly distributes the light of both circleline and miniature twin tube lamps.

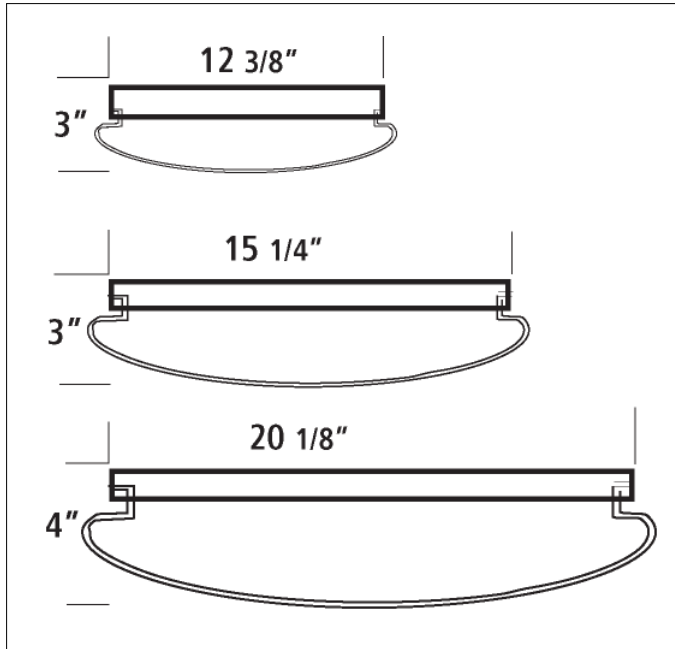

Dimensional Data



Specifications

Mounting: Back Plate provided with adequate knockouts and mounting holes for either wall or ceiling installation.

Construction: All metal parts are die formed from heavy gauge cold rolled steel. Exterior finish high quality white enamel.

Diffuser: One piece .125 smooth opal acrylic for a fully luminous light source.

Wiring: Circleline ballast are ETL-CBM, Class P ROV. HPF Standard on 22-32 watt units. All PL ballast normal power factor. High power factor ballast available upon request.

Approval: All units are Underwriter's Laboratories (UL) approved.

Ordering Information

Catalog #	Lamp	Size	Catalog #	Lamp	Size
CIRCLELINE			MINIATURE QUAD TUBES		
8102EB	1-22w	12"x12"	8102/PL13EBQ	1-13w	12"x12"
8103EB	1-32w	15"x15"	8102/2PL13EBQ	2-13w	12"x12"
8105EB	1-22w, 1-32w	15"x15"	8103/2PL13EBQ	2-13w	15"x15"
8104EB	1-40w	20"x20"	8103/3PL13EBQ	3-13w	15"x15"
8107EB	1-32w, 1-40w	20"x20"	8103/2PL18EBQ	2-18w	15"x15"
			8103/2PL26EBQ	2-26w	15"x15"
			8104/3PL13EBQ	3-13w	20"x20"
			8104/3PL18EBQ	3-18w	20"x20"
			8104/3PL26EBQ	3-26w	20"x20"

*Available with Black Base. Add suffix **BL** to catalog number.*



800E ELECTRONIC BALLAST SERIES

Installation Data

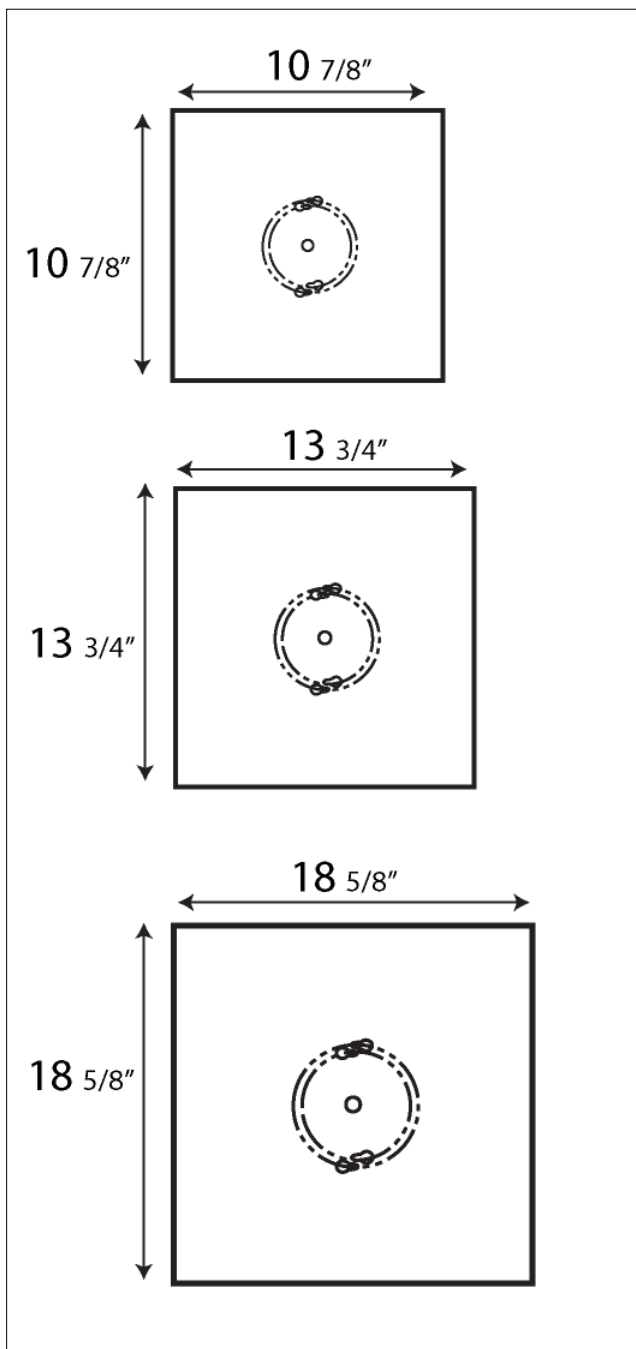

NEW ENGLAND
LIGHTING
INCORPORATED